

# *Builder Grade Hickory Finish Kitchen Cabinetry*



## **FEATURES :**

- All wood glazed maple.
- 45 degree joint doors and drawers.
- 3/4" Solid maple front, maple face-frame fastened together with mortise and tenon glued joinery.
- Fiber hard board center panel.
- Doors fastened together with glued wood joinery.
- 3/4" Solid drawers attached to an under mount drawer guide.
- 1/2" Finished plywood cabinets sides and toe-kick with wood hang rails.
- 5/8" Thick plywood shelves with full traditional overlay design on both sides.
- Elegant hand rubbed polyurethane stain finishing process ensuring long life, consistency and durability of wood.
- Finished plywood cabinets back and floor.
- Sturdy epoxy-coated metal drawer glides for smooth and quiet operation.
- Fully concealed Euro-style, adjustable metal hinges for smooth opening and proper door alignment.
- Exclusive fastening clip assembly system.
- Ready to assemble and easily put together with a unique snap-together clip fastening system.
- Assortment offers a wide variety of design options and several matching accessories for complete coordination of any kitchen design.
- Italian Hickory series molding and accessories are interchangeable with this series.

Prices subject to change without notice. Possession of this price list shall not be construed as an offer to sell the products listed.

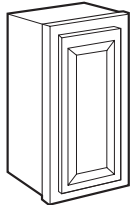
**Single Door Wall:**

W9" x 30" W9" x 36" W9" x 42"  
 W12" x 30" W12" x 36" W12" x 42"  
 W15" x 30" W15" x 36" W15" x 42"  
 W18" x 30" W18" x 36" W18" x 42"  
 W21" x 30" W21" x 36" W21" x 42"

All wall cabinets have two 5/8" adjustable plywood shelves. Door is reversible.

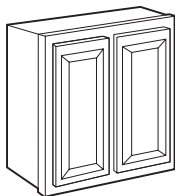
**Double Door Wall:**

W24" x 30" W24" x 36" W24" x 42"  
 W27" x 30" W27" x 36" W27" x 42"  
 W30" x 30" W30" x 36" W30" x 42"  
 W33" x 30" W33" x 36" W33" x 42"  
 W36" x 30" W36" x 36" W36" x 42"  
 W39" x 30" W39" x 36" W39" x 42"  
 W42" x 30 W42" x 42"  
 W48" x 30

All wall cabinets have two 5/8" adjustable plywood shelves.

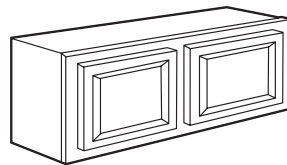
**Double Door Wall Bridge:**

W30" x 12" W30" x 15" W30" x 24"  
 W33" x 12" W33" x 15" W36" x 24"  
 W36" x 12" W36" x 15" W39" x 24"  
 W39" x 12" W39" x 15"

No shelves.

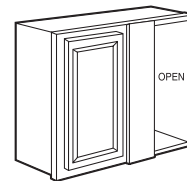
**Wall Blind Corner:**

WBC24" x 30" L/R WBC24" x 36" L/R  
 WBC27" x 30" L/R WBC27" x 36" L/R  
 WBC30" x 30" L/R WBC27" x 42" L/R  
 WBC36" x 30" L/R WBC36" x 42" L/R

All wall cabinets have two 5/8" adjustable plywood shelves. Pull cabinet away from wall corner 0-2" for door operation.

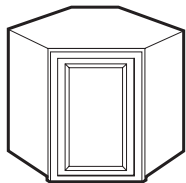
**Wall Diagonal Corner:**

WDC24" x 30" WDC24" x 36"  
 WDC24" x 42" WDC27" x 42"

Door is reversible.

All wall cabinets have two 5/8" adjustable plywood shelves. Start installation with a corner wall cabinet if kitchen has a corner.

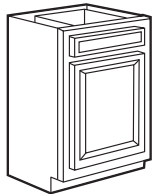
**Single Door Base:**

B9" B18"  
 B12" B21"  
 B15"

5/8" adjustable half depth plywood shelf. All base cabinets include finished toe kick. 8ft. toe kicks available.

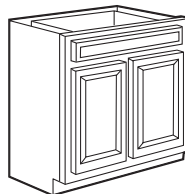
**Double Door Base:**

B24" B33" B39\*\*  
 B27" B36\*\* B42"  
 B30"

One 5/8" adjustable half depth plywood shelf. All base cabinets include finished toe kick. 8ft. toe kicks available. \*2 drawer unit.

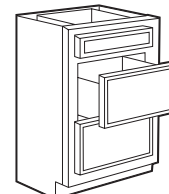
**Base Drawer Unit:**

DB12" DB24"  
 DB15" DB27"  
 DB18" DB30"  
 DB21" DB36"

Three drawers. All base cabinets include finished toe kick. 8ft. toe kicks available.

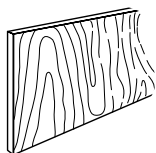
**Finished Back Panel:**

FBP 96341214(1)  
 34 1/2" H x 1/4" W x 96" L  
 FBP 369614 (1)  
 36" H x 1/4" W x 96" L  
 FBP 489612 (1)  
 48" H x 1/2" W x 96" L

**Wall Filler Strip**

WF3" (3" x 30")  
 WF6"(6" x 30")  
 WF684"(6" x 84")  
 WF396"(3" x 96")  
 WF636"(6" x 36")

**BF3" 30" BF6 (3" x 34 1/2") / (6" x 34 1/2")**

**Base Filler w/ Toe Kick:**  
 (Line art may not reflect exact specifications.)

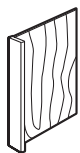
**Decorative Base End Panel****(BEP 3):**

34 1/2" H x 24" W x 1/2" D  
 Refrigerator Panel (REP2):  
 24" x 96"  
 Refrigerator Panel (REP3):  
 12" x 84"

Includes 3" trimmable filler; finished on both sides.

**Decorative Wall Filler Strips**

A12WF - 3"W x 12"H  
 A15WF - 3"W x 15"H  
 A24WF - 3"W x 24"H  
 A30WF - 3"W x 30"H  
 A42WF - 3"W x 42"H

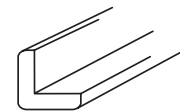
**Outside Corner Molding: OSCSC5**

3/4" W x 96" L x 1/4" Thick

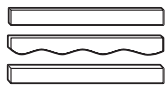

**TK8' Finished Toe Kick**  
**VAS36" Sculptured Valance**  
**VAS48" Sculptured Valance**  
**VA36" Plain Valance**  
**VA48" Plain Valance**

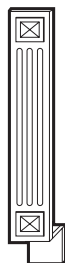
**Decorative Wall Filler Strips w/ Toe Kick**

A3BF - 3"W x 34 1/2"H  
 A6BF - 6"W x 34 1/2"H

**Batten Molding: SC2**

3/4" W x 96" L x 1/8" Thick

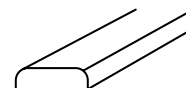

**CM96A Crown Molding: Plain**  
 5/8"W x 3"H x 96"L  
**CM96B Crown Molding: Scallop Trim**  
 5/8"W x 4"H x 96"L  
**CM96C Crown Molding: Rope Trim**  
 5/8"W x 4"H x 96"L  
**CM96D Crown Molding: Dentil Trim**  
 5/8"W x 4"H x 96"L

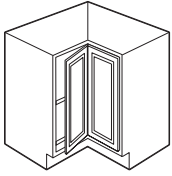

**Lazy Susan:**

LS3312S LS3612S  
LS3612

Two 28" carousels. One at base, one at midpoint (12 1/2" between carousels). All wood Lazy-Susan carousels. All base cabinets include finished toe kick. 8ft. toe kicks available. Durable ball-bearing design.

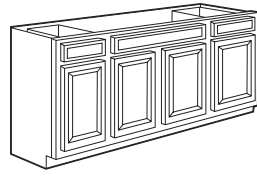

**SB60" Wide Sink Base:**

All base cabinets include finished toe kick. 8ft. toe kicks available. Can be used for a drop-in range. Includes 2 operable drawer units and four doors.

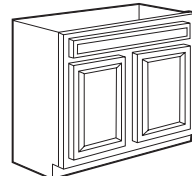

**Sink Base:**

SB-27\*\* SB-36"  
SB-30\*\*\* SB-39\*\*\*  
SB-33\*\*\* SB-42\*\*\*\*

All base cabinets include finished toe kick. 8ft. toe kicks available. Can be used for a drop-in range.

\*SB-30" has one false drawer front.

\*\*SB-36" has two false drawer fronts & doors.

\*\*\*SB-42" has three false drawer fronts.

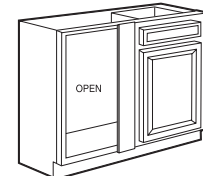

**Base Blind Corner:**

BBC30-33 L/R BBC42-45 L/R  
BBC36-39 L/R BBC45-48 L/R

One 5/8" half depth adjustable plywood shelf. All base cabinets include finished toe kick. 8ft. toe kicks available. Door is reversible. Pull cabinet side away from wall corner 6"- 8 1/4".

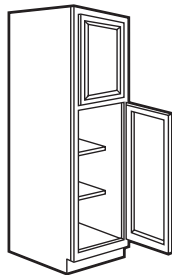

**Wall Pantry:**

WP 84"H x 18"W x 24"D - 2 doors  
WP 84"H x 24"W x 24"D - 4 doors  
WP 90"H x 18"W x 24"D - 2 doors  
WP 90"H x 24"W x 24"D - 4 doors  
WP 96"H x 18"W x 24"D - 2 doors  
WP 96"H x 24"W x 24"D - 4 doors  
WP 96"H x 30"W x 24"D - 4 doors

All base cabinets include finished toe kick. 8ft. toe kicks available. Two 5/8" half depth adjustable plywood shelves in bottom.

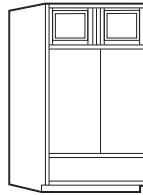

**Double Oven Cabinet:**

POC 30" x 84"  
POC 30" x 96"

**Oven Cabinet:**

OC 30" x 84"  
OC 33" x 84"  
OC 33" x 90"  
OC 30" x 96"  
OC 33" x 96"

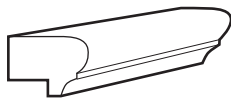
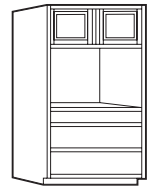

**Under Cabinet Trim Molding**

LRM8 - 1" W x 1 1/2" H x 96" L

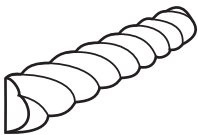

**Rope Molding**

RM8 - 3/8" T x 3/4" H x 96"L

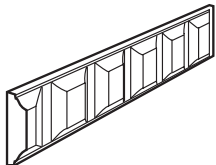

**Dentil Edge Molding**

DM4 - 1/2" W x 3/4" H x 48"L



**Decorative Country Valances**

CTVAL36 - 5" H x 36" L  
CTVAL48 - 5" H x 48" L

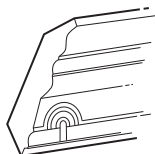

**Crown Molding**

LCM8 - 4/5" W x 4 1/2" H x 96"L

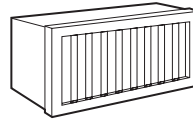

**Wall Cabinets - Plate Holder**

W3015PL - 30"W x 12"D x 15"H  
W3615PL - 36"W x 12"D x 15"H  
W3018PL - 30"W x 12"D x 18"H  
W3618PL - 36"W x 12"D x 18"H

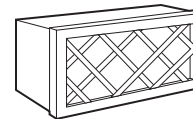

**Wall Cabinets - Wine Rack**

W3015WR - 30" W x 12" D x 15" H  
W3615WR - 36" W x 12" D x 15" H  
W3018WR - 30" W x 12" D x 18" H  
W3618WR - 36" W x 12" D x 18" H

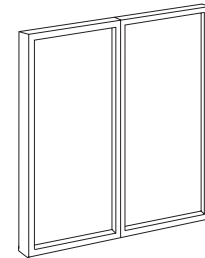

**Glass Door Frames**

W1530GD 2(PCS)/Set  
W1830GD 2(PCS)/Set  
W2430GD 2(PCS)/Set  
W3030GD 2(PCS)/Set  
W3630GD 2(PCS)/Set  
W2436GD 2(PCS)/Set  
W2442GD 2(PCS)/Set  
WDC2430GD 2(PCS)/Set  
WDC2436GD 2(PCS)/Set

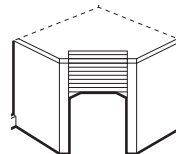

**Corner Appliance Garage**

TAG1224

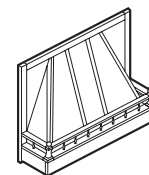

**Wood Oven Hood**

WH30 - 30"W x 24"H  
WH36 - 36"W x 24"H

**WALL CABINETS** — Standard 12" Depth. First letter(s) represent wall cabinet description (W), first numbers indicate cabinet width and the last two numbers indicate cabinet height.

**BASE CABINETS** — Standard 24" Depth and 34.5" Height. First letter(s) indicate base cabinet description (B) and first numbers indicate cabinet width.